

ENGLISH ONLY LABELS

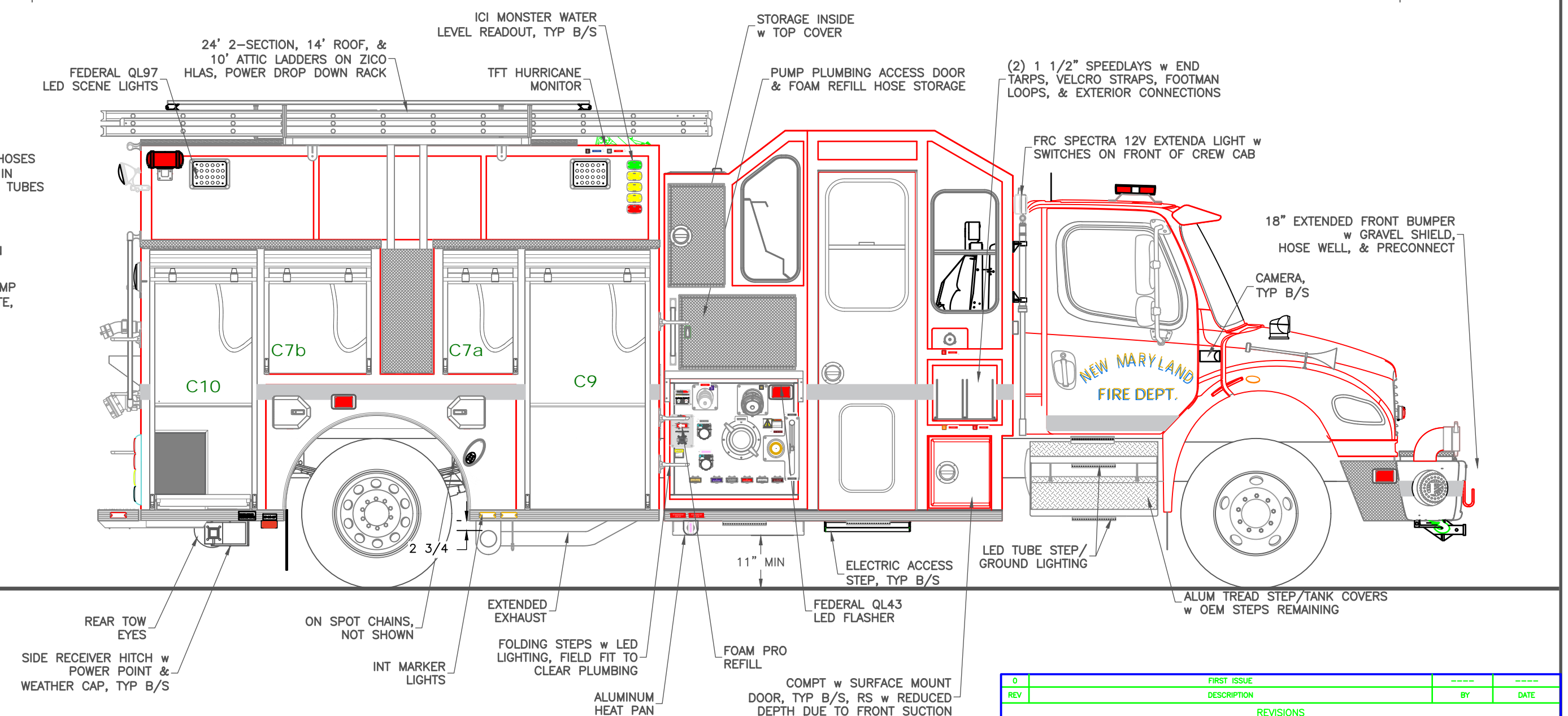
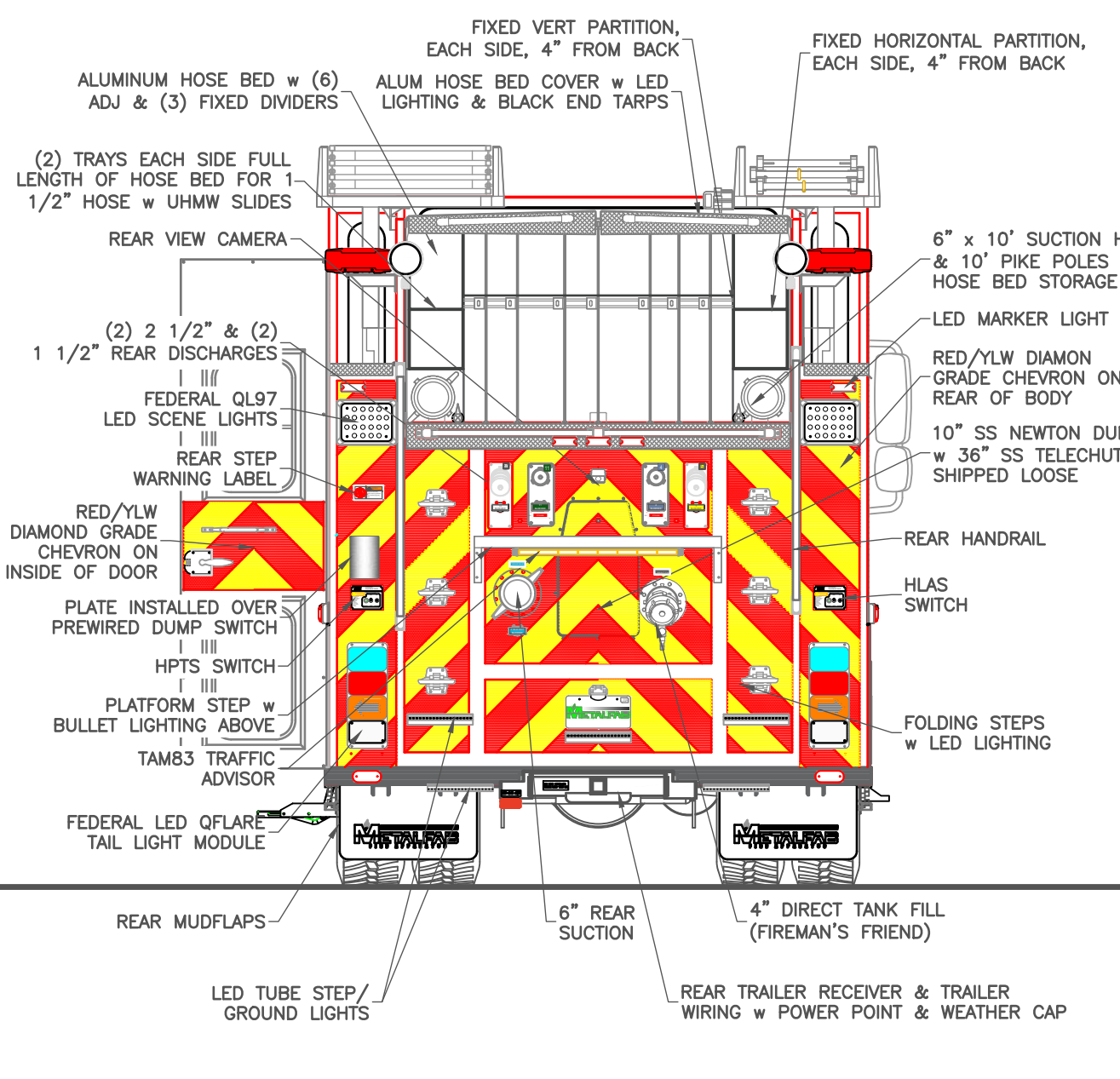
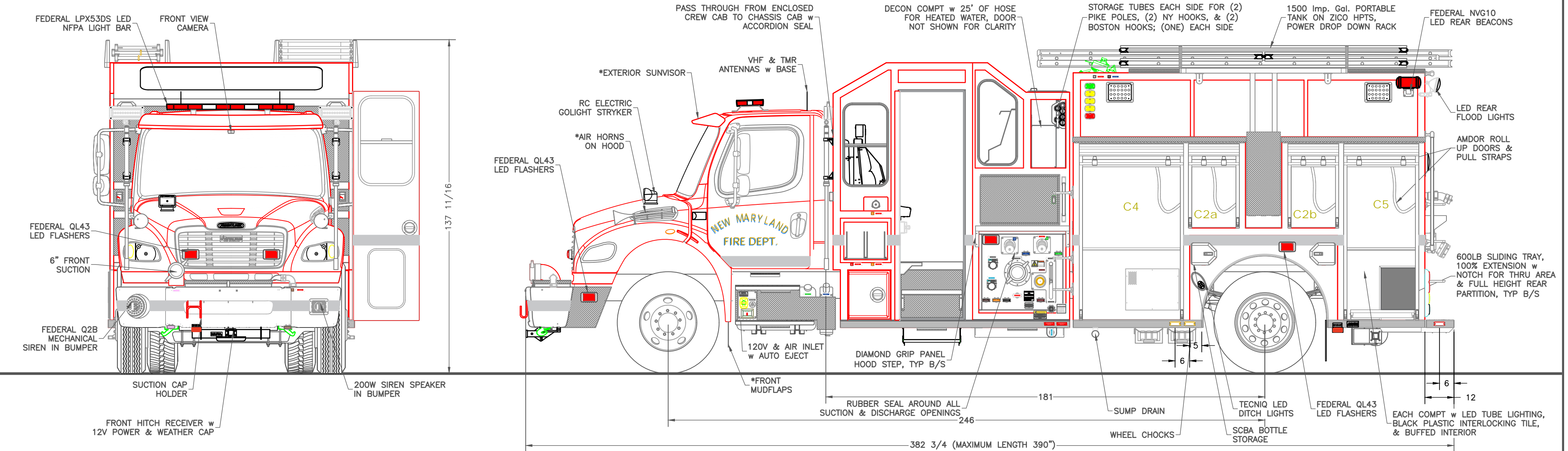

CHASSIS: FREIGHTLINER M2 106 2 DOOR
 PUMP: HALE 1250 QMAX-XS
 TANK: 1200 Imp. Gal. POLYPROPYLENE
 1 - 50 Imp. Gal. FOAM CELL
 FOAM: FOAMPRO 2002

SUCTION: 1 - 6" LEFT (ELEC. GATE)
 1 - 6" RIGHT (ELEC. GATE)
 1 - 6" FRONT (4" PIPE, ELEC. GATE)
 1 - 6" REAR (4" PIPE, ELEC. GATE)
 1 - 4" TANK TO PUMP
 1 - 2 1/2" LEFT
 1 - 2 1/2" RIGHT

DISCHARGES: 1 - 5" RIGHT (3" PIPE)
 2 - 3" MONITOR (FOAM)
 (2) VALVES; (ONE) FOAM & (ONE) WATER
 2 - 2 1/2" LEFT (ONE FOAM)
 2 - 2 1/2" REAR
 1 - 2 1/2" RIGHT (FOAM)

1 - 2 1/2" TANK FILL
 2 - 1 1/2" REAR (FOAM)
 2 - 1 1/2" SPEEDLAYS (FOAM)
 1 - 1 1/2" TRASH LINE (FOAM)

REV	DESCRIPTION	BY	DATE
0	FIRST ISSUE		
REVISIONS			
NEW MARYLAND FIRE DEPARTMENT		TITLE GENERAL ARRANGEMENT	
JOB No.	23278		
DRAWN BY	HDS		
DATE	MAY 6, 2024	DRAWING NO. 23278-19 PG 1 OF 4	
METALFAB LTD. 847 CENTRAL ST. CENTREVILLE NB. CANADA E7K 2E8		REV 0	

-ALL ALUMINUM CONSTRUCTION - ALL DIMENSIONS ARE IN INCHES & APPROXIMATE

ENGLISH ONLY LABELS

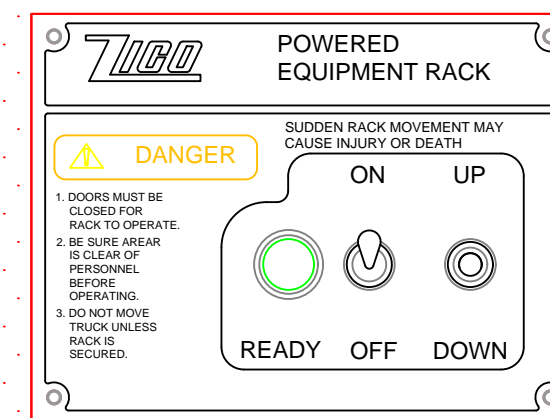
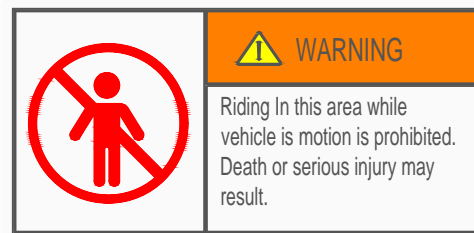
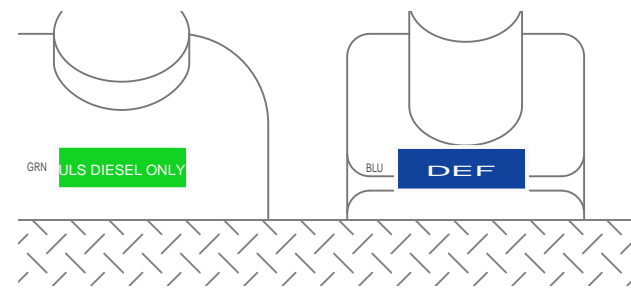
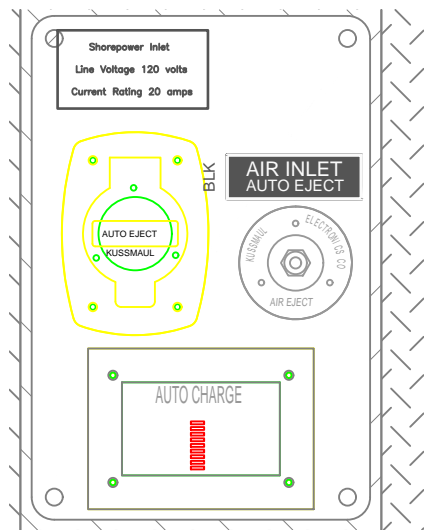
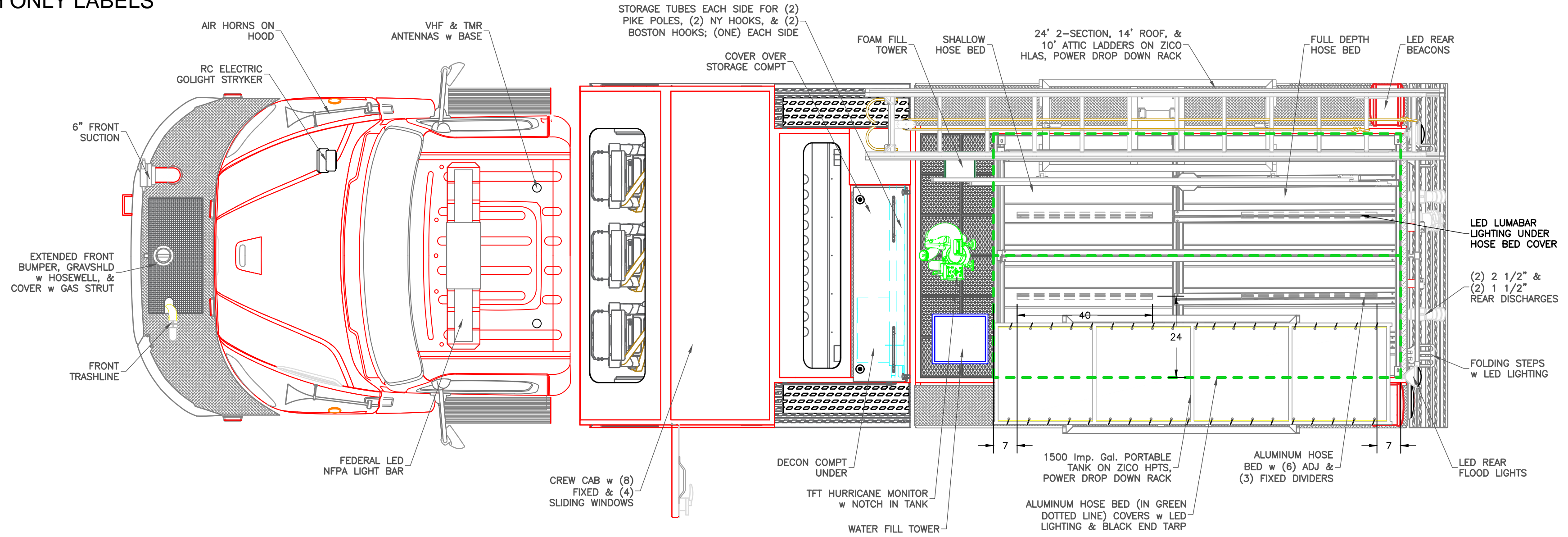

REAR LS FOR PTS

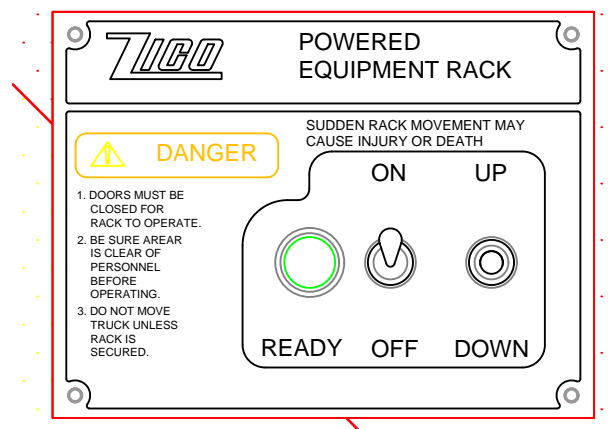

REAR RS FOR LADDERS

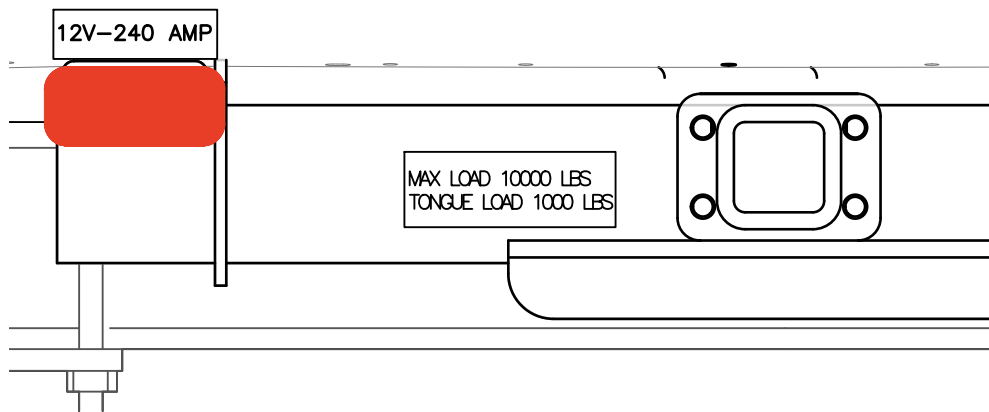

FRONT & REAR RECEIVERS

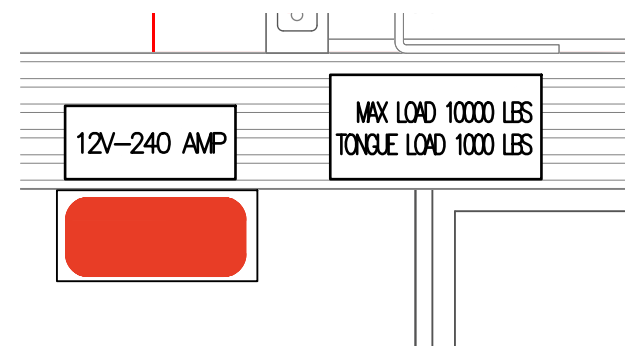

SIDE RECEIVERS

-ALL ALUMINUM CONSTRUCTION - ALL DIMENSIONS ARE IN INCHES & APPROXIMATE

0	FIRST ISSUE	---	---
REV	DESCRIPTION	BY	DATE
REVISIONS			
NEW MARYLAND FIRE DEPARTMENT		TITLE TOP VIEW & TAGS	
JOB No.	23278		
DRAWN BY	HDS		
DATE	MAY 6, 2024		
METALFAB LTD. 847 CENTRAL ST. CENTREVILLE NB. CANADA E7K 2E8		DRAWING NO. 23278-19 PG 2 OF 4	REV 0

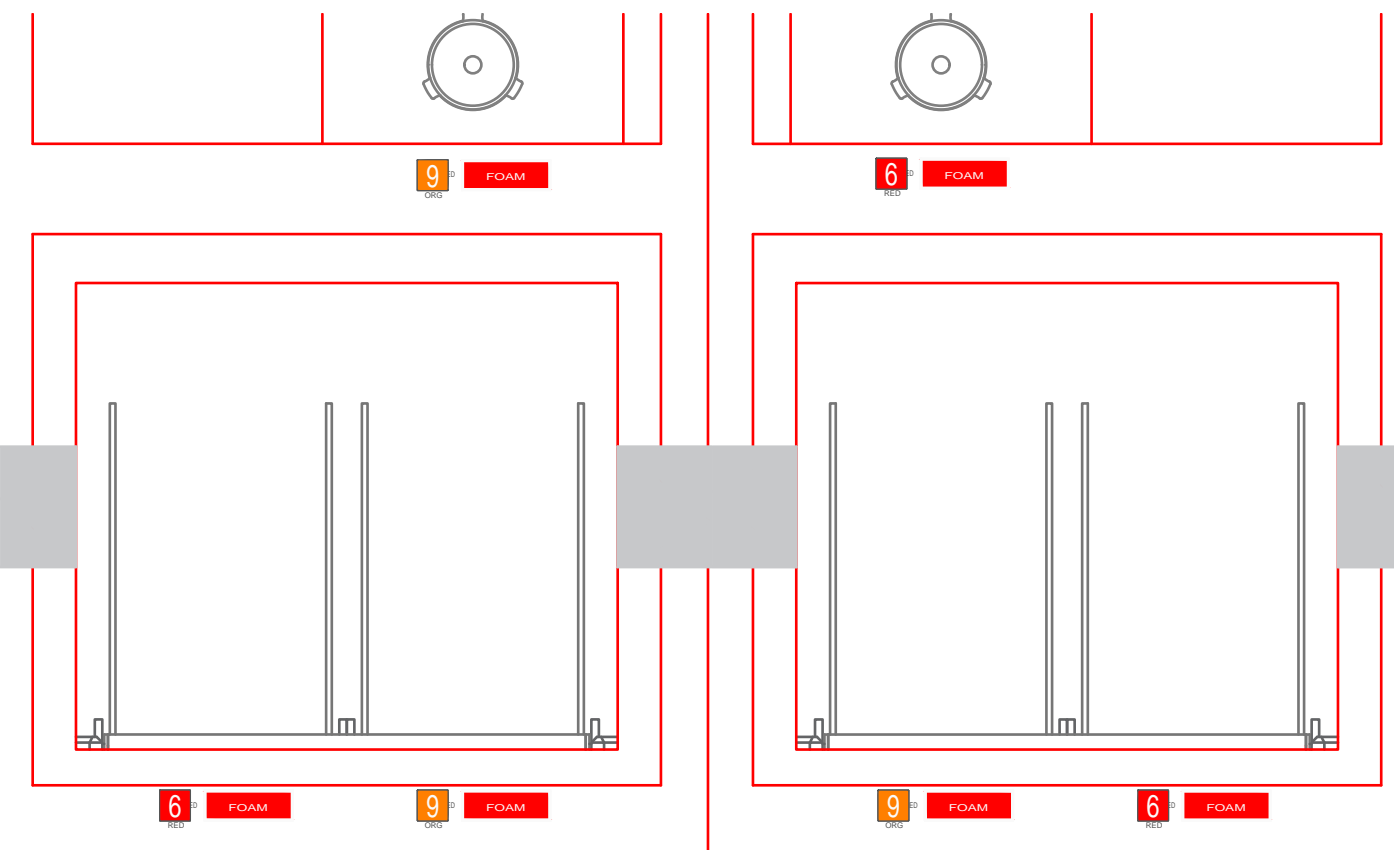
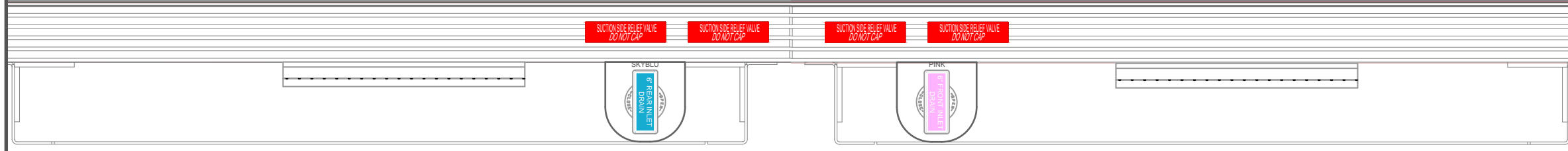
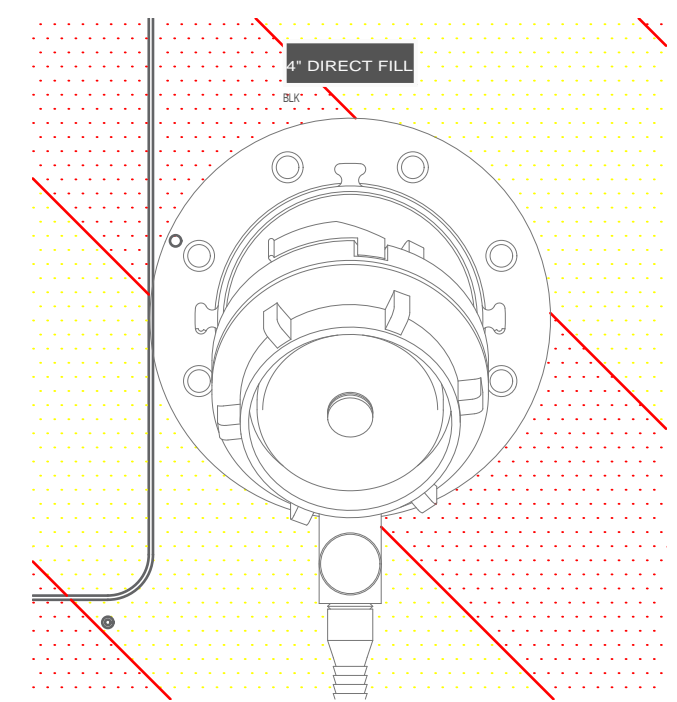
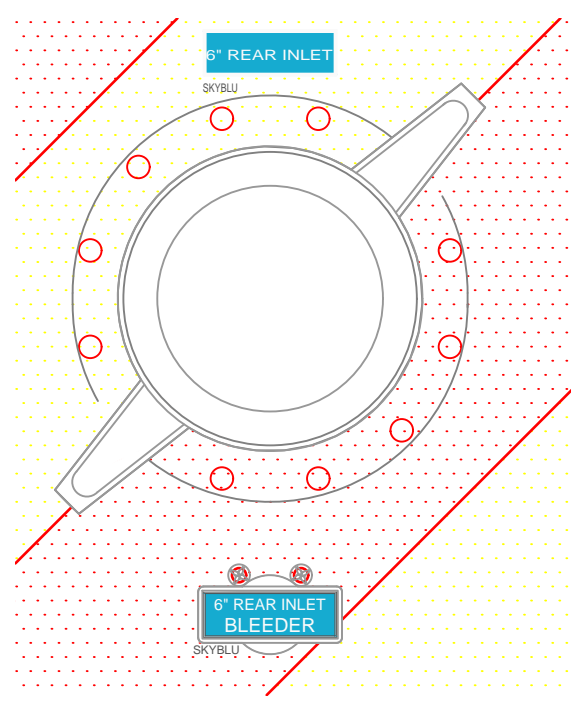
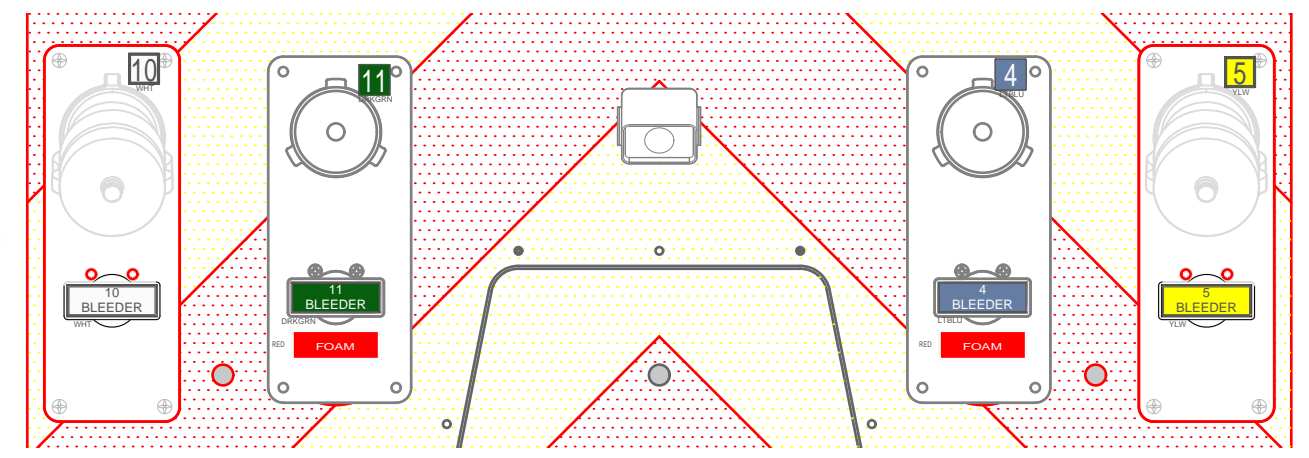
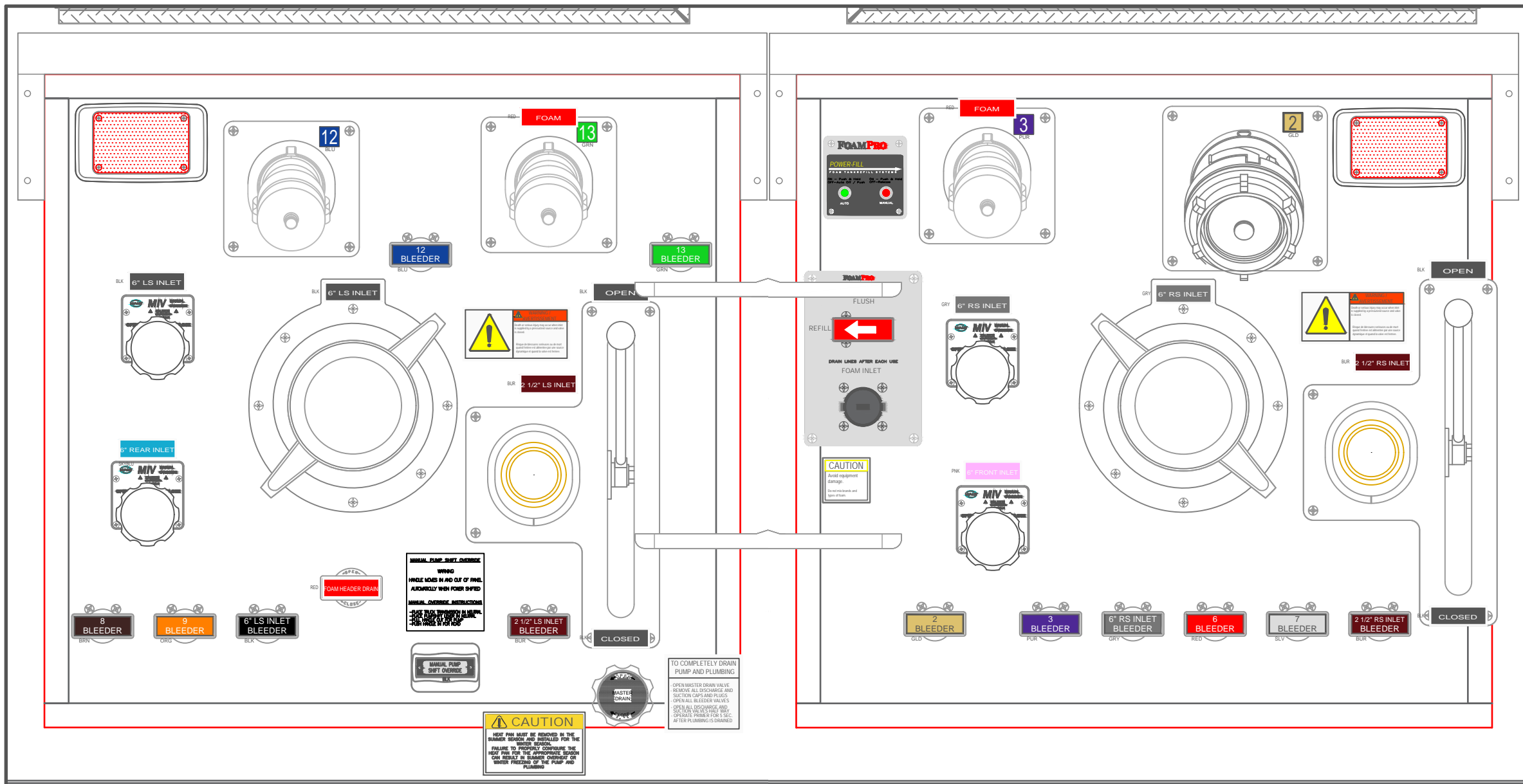

LEFT SIDE

RIGHT SIDE

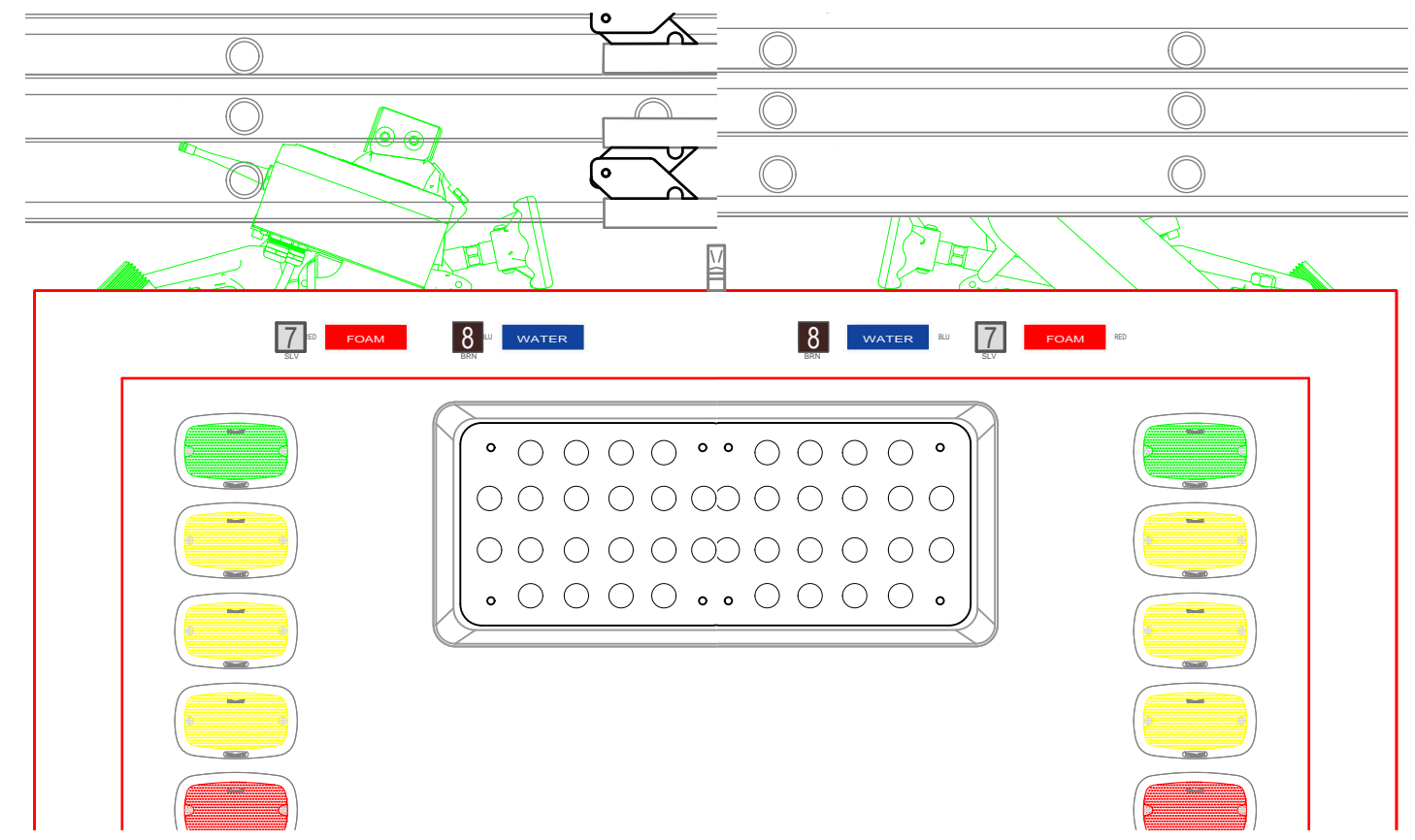

LEFT SIDE

RIGHT SIDE

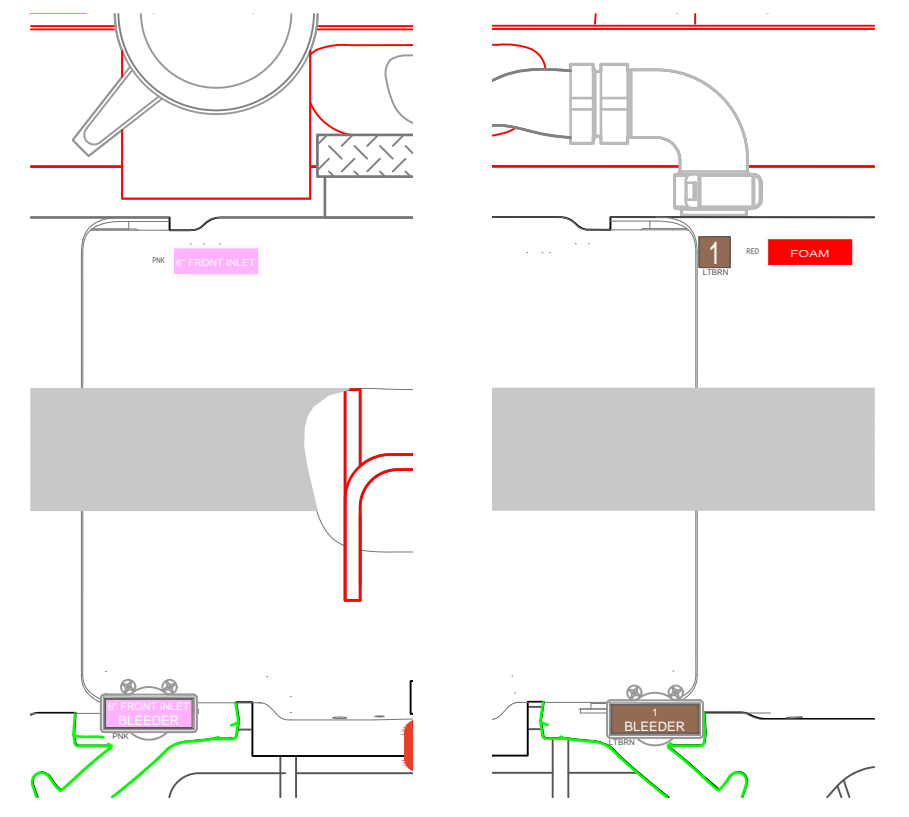

ENGLISH ONLY LABELS

REV	DESCRIPTION	BY	DATE
0	FIRST ISSUE		
REVISIONS			
TITLE		SIDE PANELS	
NEW MARYLAND FIRE DEPARTMENT			
JOB No.	23278		
DRAWN BY	HDS		
DATE	MAY 6, 2024		
METALFAB LTD. 847 CENTRAL ST. CENTREVILLE NB. CANADA E7K 2E8		DRAWING NO.	23278-19 PG 3 OF 4
		REV	0

-ALL ALUMINUM CONSTRUCTION - ALL DIMENSIONS ARE IN INCHES & APPROXIMATE

ENGLISH ONLY LABELS

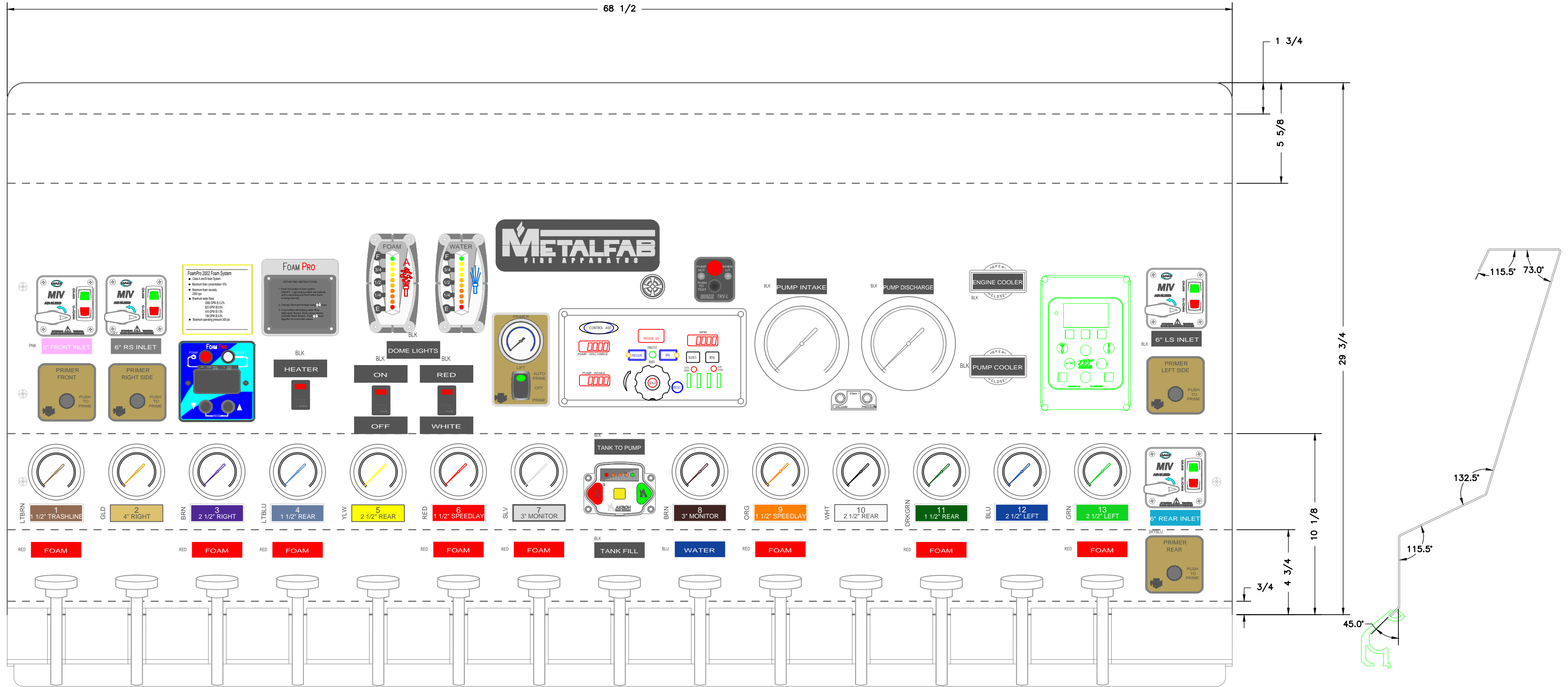

WARNING
 Do not operate this vehicle without the operator.
 Do not operate or perform any work on this vehicle, or any other vehicle, until you have read, understood, and signed the operator's manual. The operator's manual is located in the operator's compartment.
 Do not operate this vehicle until you have read, understood, and signed the operator's manual. The operator's manual is located in the operator's compartment.
 Do not operate this vehicle until you have read, understood, and signed the operator's manual. The operator's manual is located in the operator's compartment.

WARNING
 Not to be used for anything other than its intended purpose.
 Do not use this vehicle for anything other than its intended purpose.
 Do not use this vehicle for anything other than its intended purpose.
 Do not use this vehicle for anything other than its intended purpose.
 Do not use this vehicle for anything other than its intended purpose.

WARNING
 Riding in this area while vehicle is motor is prohibited. Death or serious injury may result.

WARNING / AVERTISSEMENT
 Do not use this vehicle for anything other than its intended purpose.
 Do not use this vehicle for anything other than its intended purpose.
 Do not use this vehicle for anything other than its intended purpose.
 Do not use this vehicle for anything other than its intended purpose.

- ALL ALUMINUM CONSTRUCTION - ALL DIMENSIONS ARE IN INCHES & APPROXIMATE

REV	DESCRIPTION	BY	DATE
0	FIRST ISSUE		
REVISIONS			
NEW MARYLAND FIRE DEPARTMENT		TITLE OPERATOR'S PANEL	
JOB No.	23278		
DRAWN BY	HDS		
DATE	MAY 6, 2024		
METALFAB LTD. 847 CENTRAL ST. CENTREVILLE NB. CANADA E7K 2E8		DRAWING NO. 23278-19 PG 4 OF 4	
		REV 0	