

**ENGLISH ONLY LABELS**

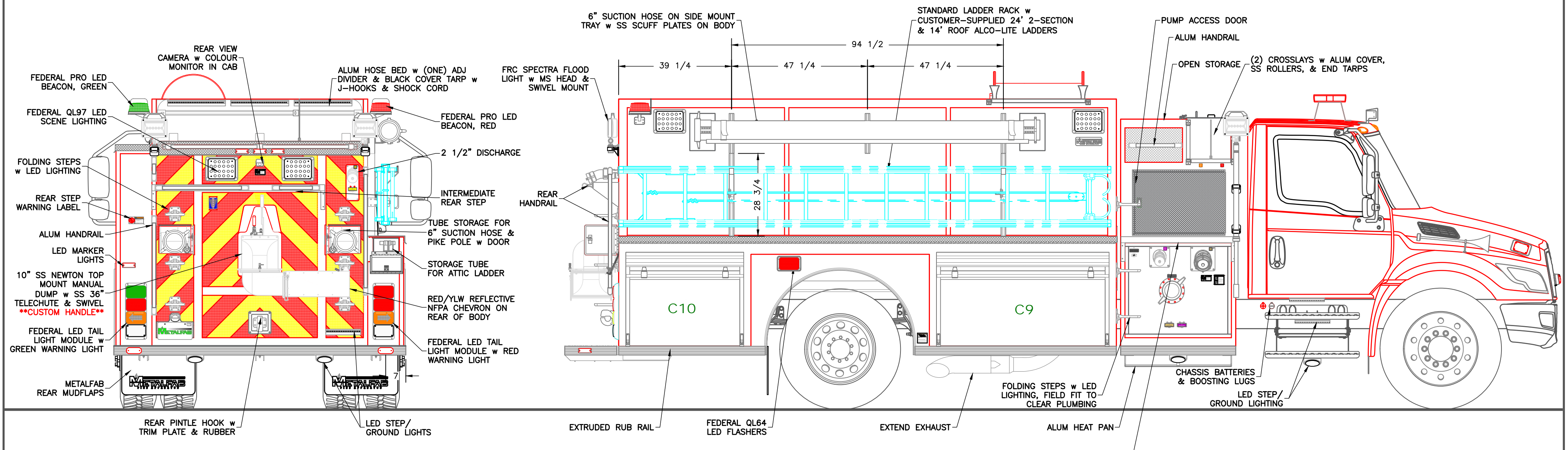

CHASSIS: INTERNATIONAL MV607 360 HP 2-DOOR  
 PUMP: HALE RSD-J PTO DRIVE 1250 USGPM  
 TANK: 1500 US GALLONS POLYPROPYLENE  
 FOAM: N/A

SUCTION: 1 - 6" LEFT (NOT GATED)  
 1 - 6" RIGHT (NOT GATED)  
 1 - 3" TANK TO PUMP (4" PLUMB)  
 1 - 2 1/2" LEFT

DISCHARGES: 1 - 4" RIGHT (3" PLUMBING)  
 2 - 2 1/2" LEFT  
 1 - 2 1/2" RIGHT  
 1 - 2 1/2" REAR

1 - 2" TANK FILL  
 2 - 1 1/2" CROSSLAYS  
 1 - HOSE REEL

REV	DESCRIPTION	BY	DATE
0	FIRST ISSUE		
REVISIONS			
TITLE		GENERAL ARRANGEMENT	
ALLAGASH FIRE DEPARTMENT			
JOB No.	23121		
DRAWN BY	HDS		
DATE	JANUARY 21, 2025		
METALFAB LTD. 847 CENTRAL ST. CENTREVILLE NB. CANADA E7K 2E8		DRAWING NO.	23121-19 PG 1 OF 3
		REV	0

\* - INCLUDED w CHASSIS

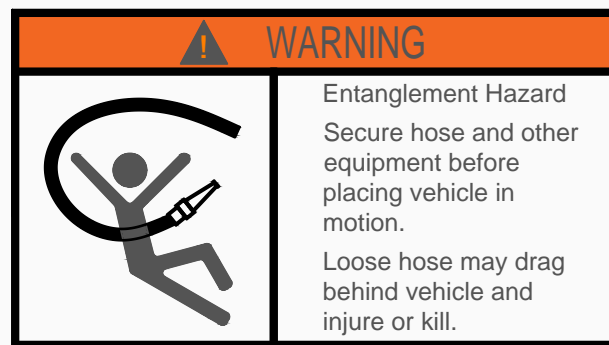
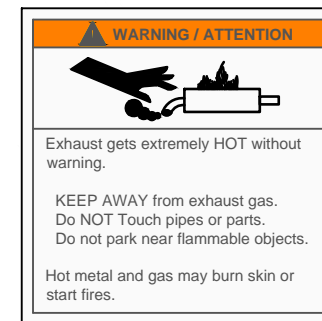
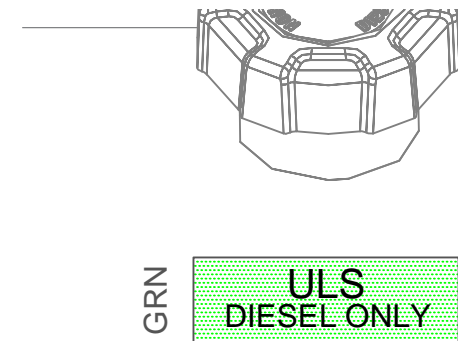
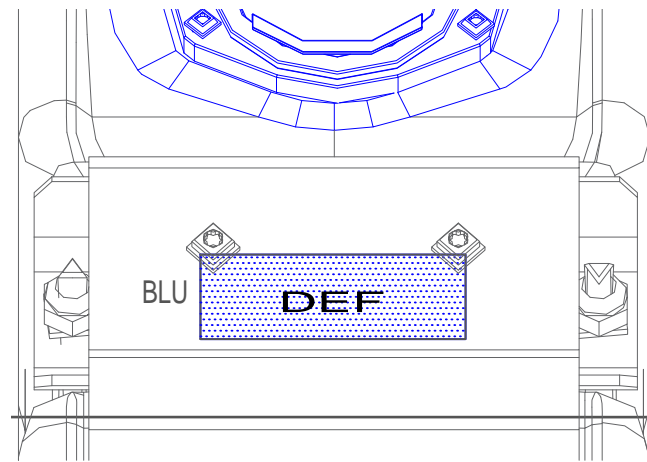
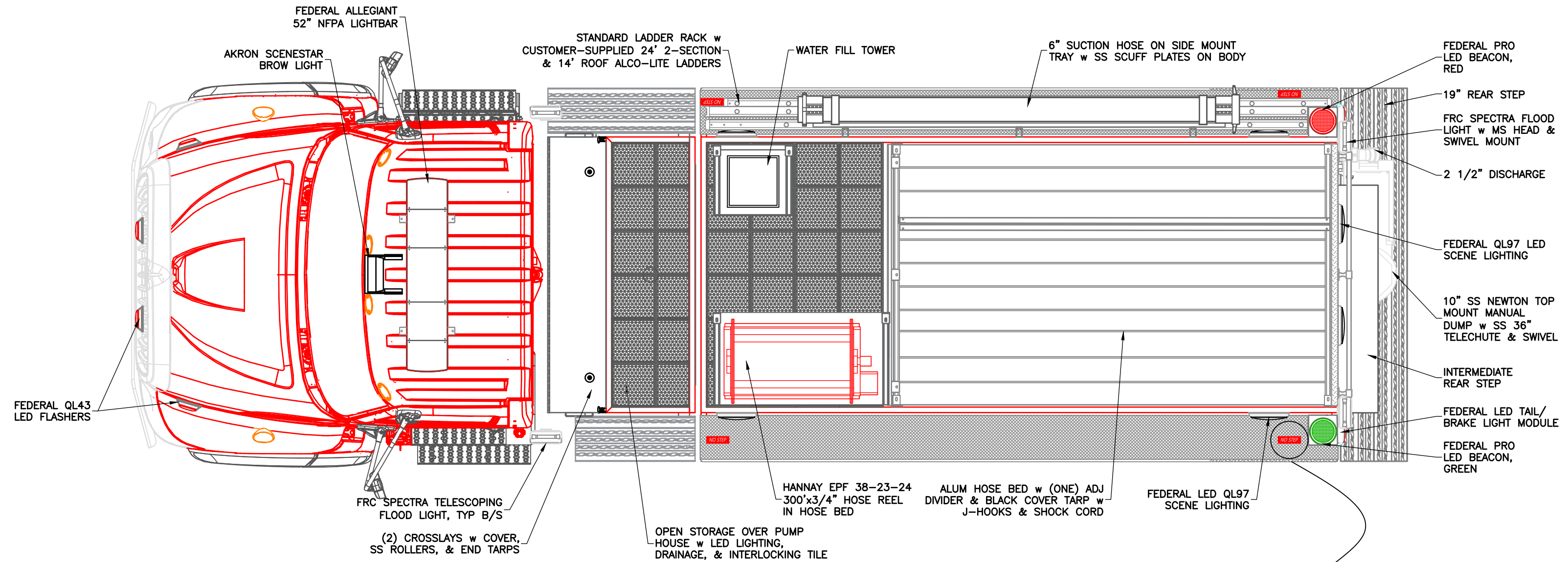

ENGLISH ONLY LABELS

\* - INCLUDED w CHASSIS

REV	DESCRIPTION	BY	DATE
0	FIRST ISSUE		
REVISIONS			
<b>ALLAGASH FIRE DEPARTMENT</b> JOB No. 23121 DRAWN BY HDS DATE JANUARY 21, 2025 METALFAB LTD. 847 CENTRAL ST. CENTREVILLE NB. CANADA E7K 2E8		TITLE TOP VIEW  DRAWING NO. 23121-19 PG 2 OF 3 REV 0	

ENGLISH ONLY LABELS

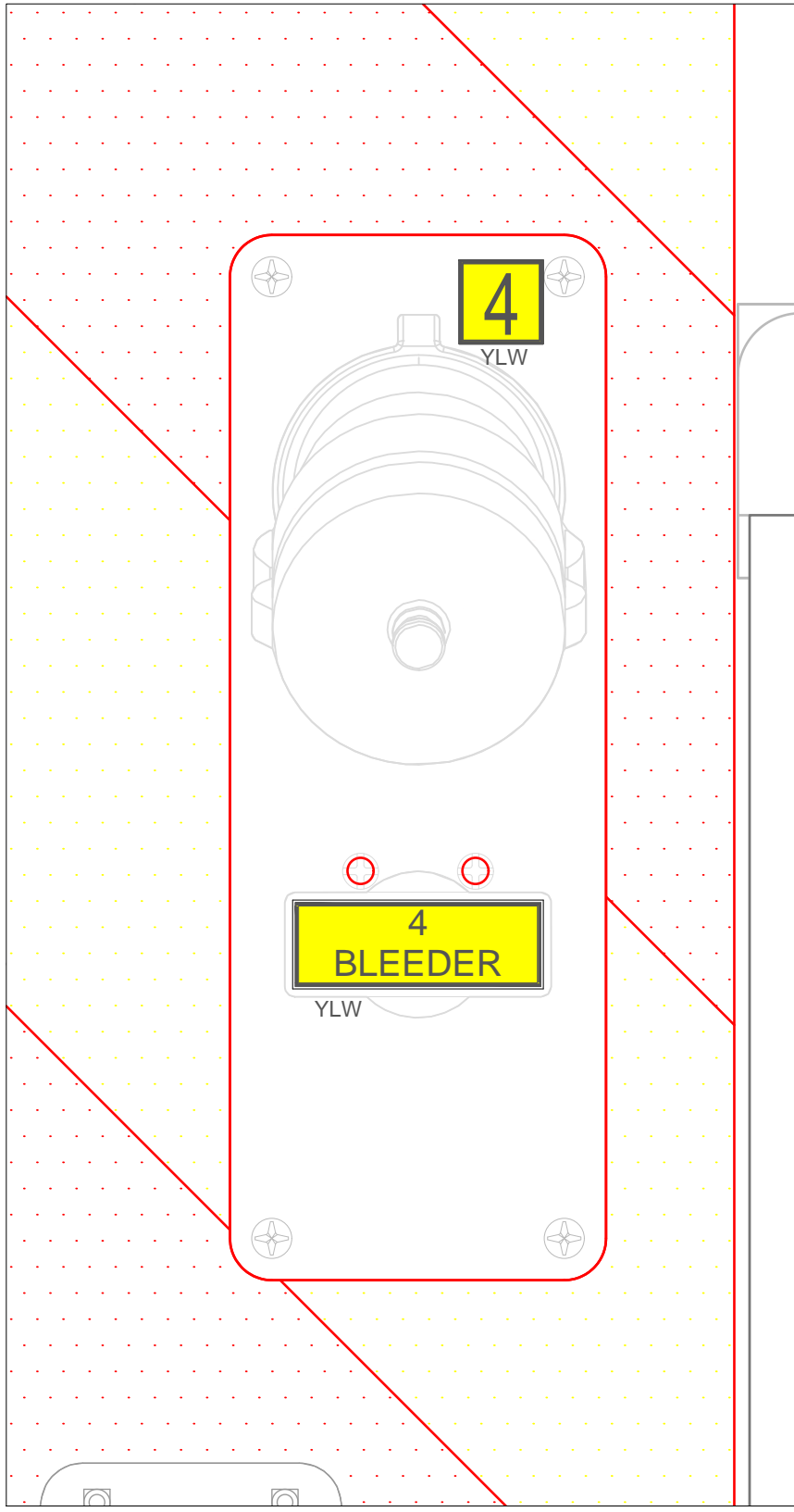
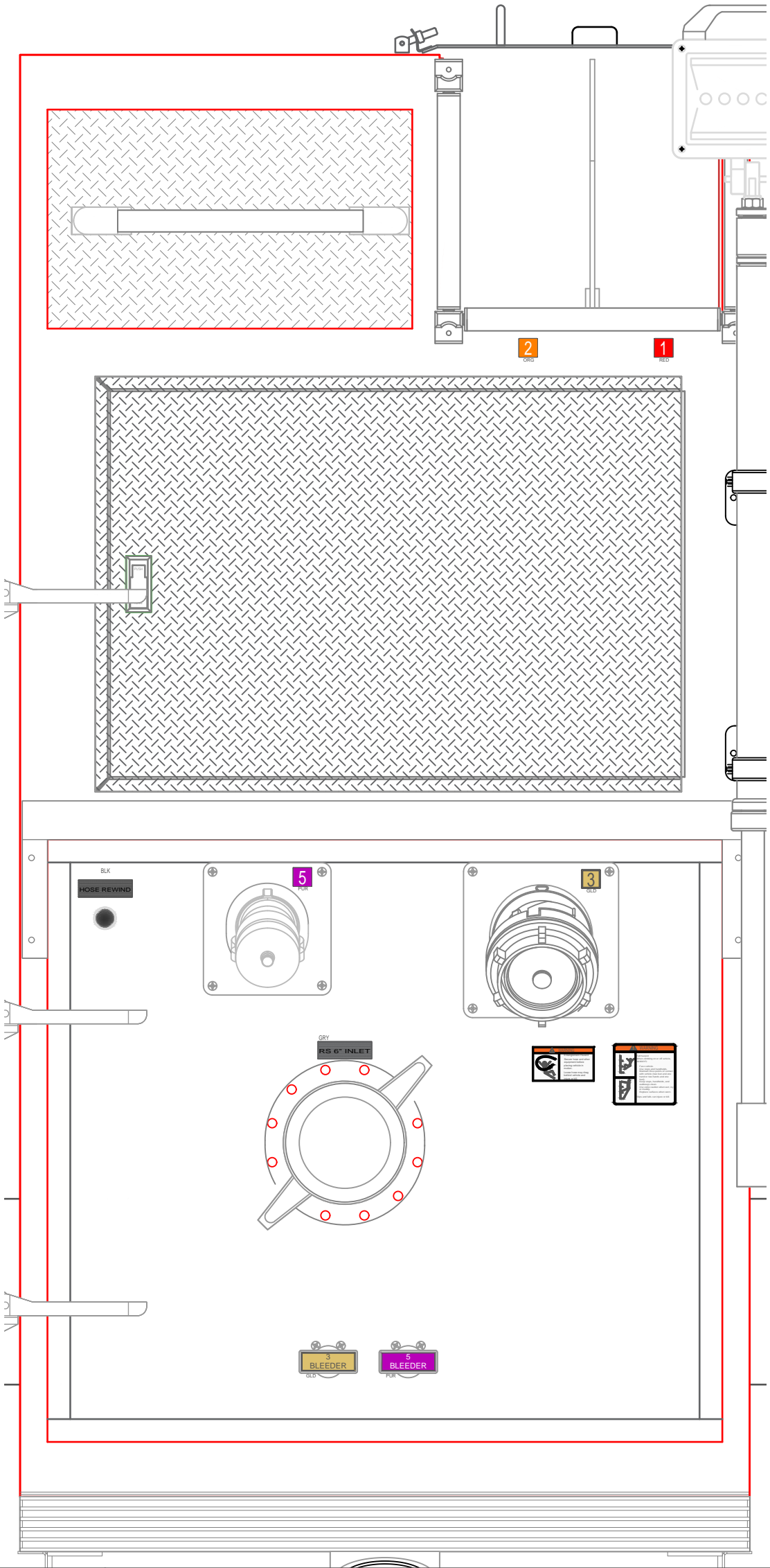
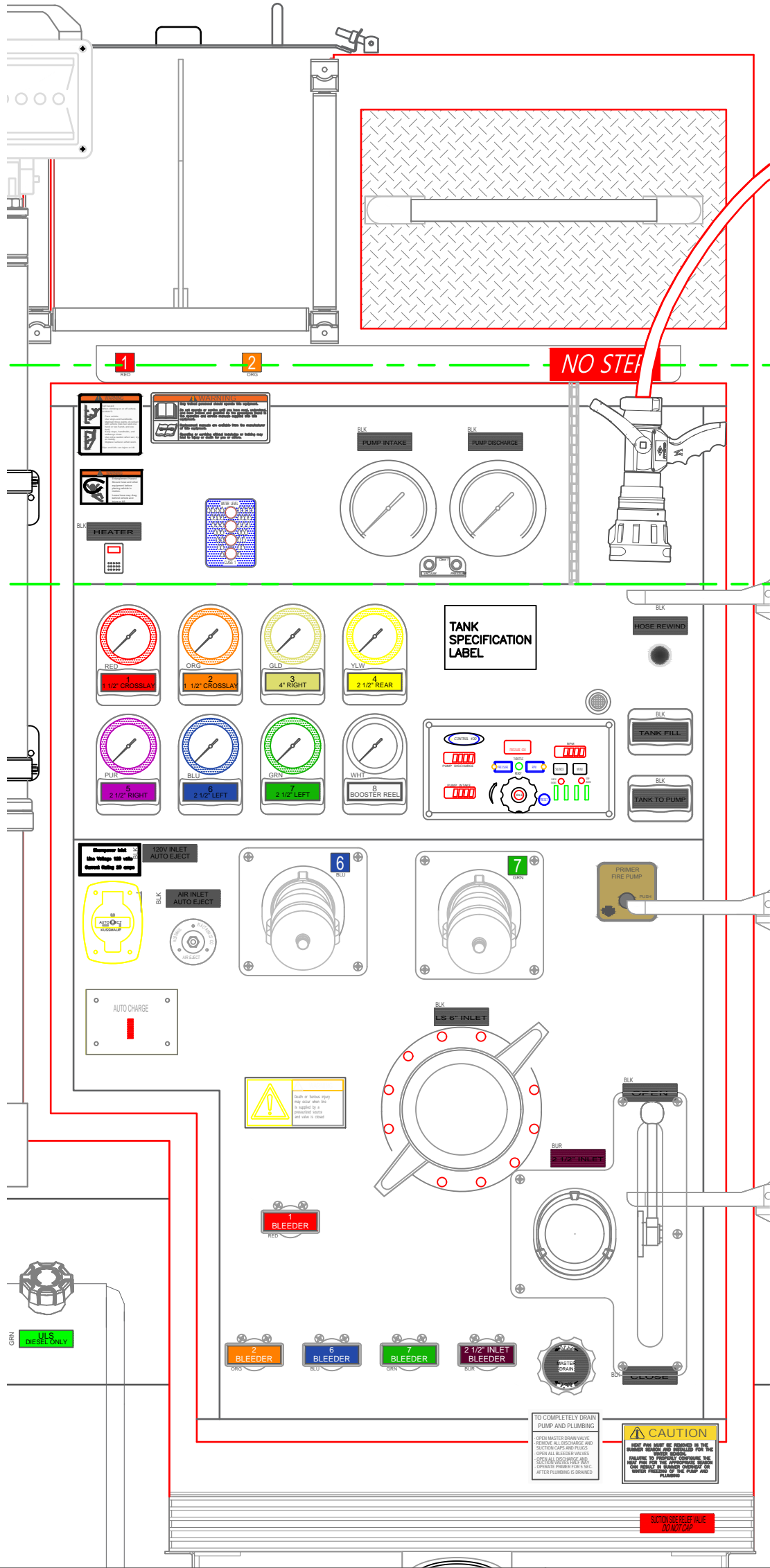

REV	DESCRIPTION	BY	DATE
0	FIRST ISSUE		
REVISIONS			
ALLAGASH FIRE DEPARTMENT		TITLE OPERATOR'S PANELS	
JOB No. 23121			
DRAWN BY HDS			
DATE JANUARY 21, 2025		DRAWING NO. 23121-19 PG 3 OF 3	
METALFAB LTD. 847 CENTRAL ST. CENTREVILLE NB. CANADA E7K 2E8		REV 0	

\* - INCLUDED w CHASSIS