

REV	DESCRIPTION	BY	DATE
4	UPDATE TO MATCH CUSTOMER VISIT CHANGES CHANGE ORDERS D & E	HDS	OCT 30, 2025
3	REMOVED FOLDING STEPS ABOVE INT STEP ON RS & LENGTHENED VERTICAL HANDRAIL	HDS	OCT 24, 2025
2	UPDATED TO MATCH CHANGE ORDER B	HDS	OCT 3, 2025
1	ADJUSTED PUMPHOUSE STAINLESS AND PLUMBING LAYOUT	JUL	2025-08-12
0	FIRST ISSUE		

CHASSIS: FREIGHTLINER M2 112 2-DOOR	SUCTION: 1 - 6" LEFT (ELECTRIC GATE)	DISCHARGES: 1 - 4" RIGHT (ELECTRIC)	1 - 3" TANK FILL (ELECTRIC)
PUMP: HALE DSD 1250 IGPM	1 - 6" RIGHT (ELECTRIC GATE)	2 - 2 1/2" LEFT	2 - 1 1/2" CROSSLAYS (FOAM)
TANK: 2000 Imp. Gal. POLYPROPYLENE	1 - 4" TANK TO PUMP (ELECTRIC)	1 - 2 1/2" RIGHT	
1 - 30 Imp. Gal. FOAM CELL	1 - 2 1/2" LEFT	2 - 2 1/2" REAR (FOAM)	
FOAM: FOAM PRO 2002		EACH 2 1/2" DISCHARGE w 1 1/2" REDUCER & CAP	

BROOKFIELD FIRE DEPARTMENT	TITLE: GENERAL ARRANGEMENT
JOB No. 23142	
DRAWN BY HDS	
DATE: JUNE 16, 2025	
METALFAB LTD. 847 CENTRAL ST. CENTREVILLE NB. CANADA E7K 2E8	
DRAWING NO. 23142-19 PG 1 OF 3	REV 4

-ALL ALUMINUM CONSTRUCTION - ALL DIMENSIONS ARE IN INCHES

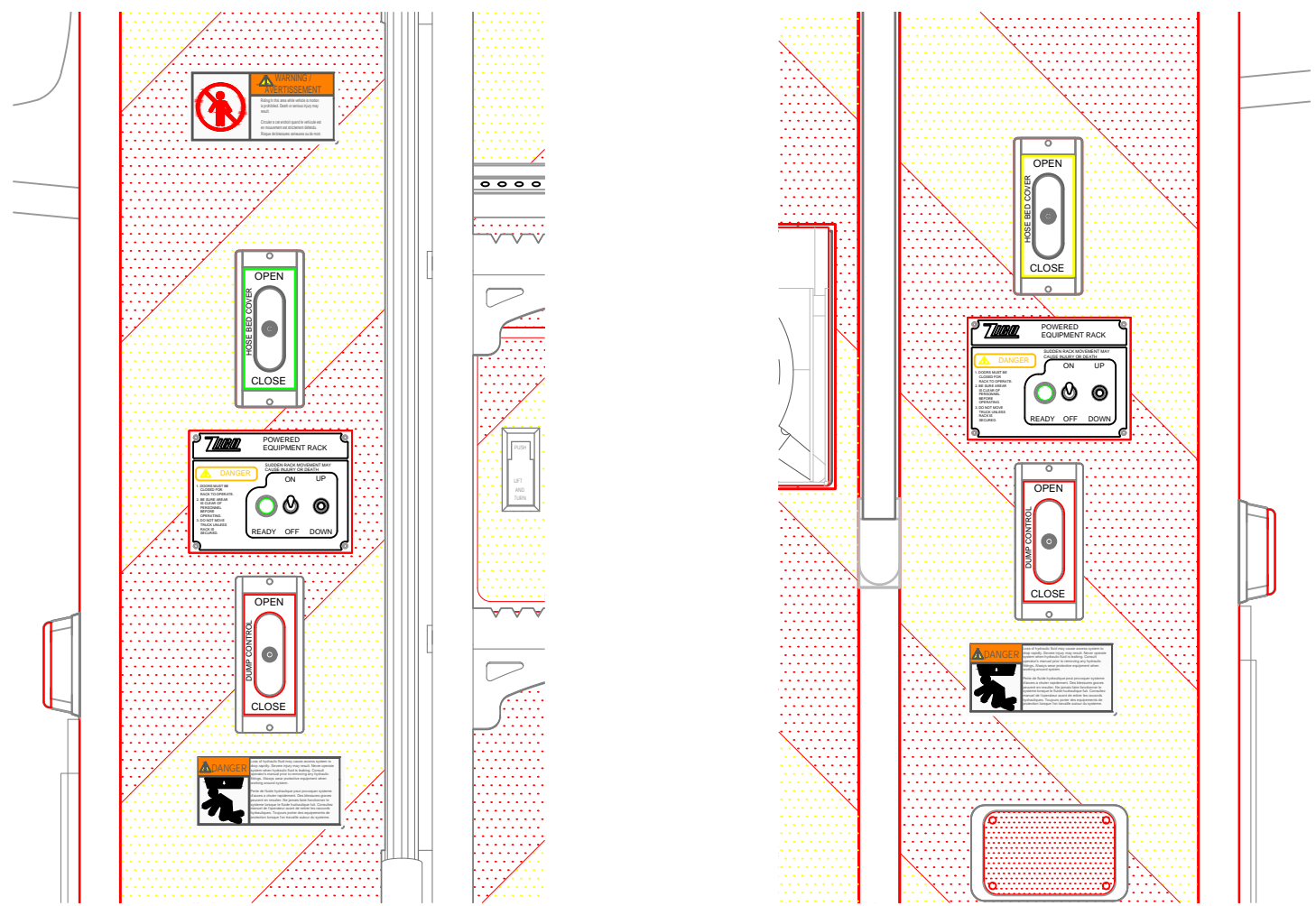
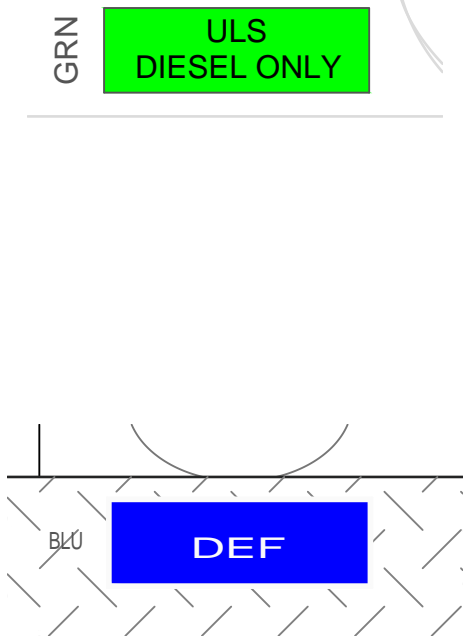
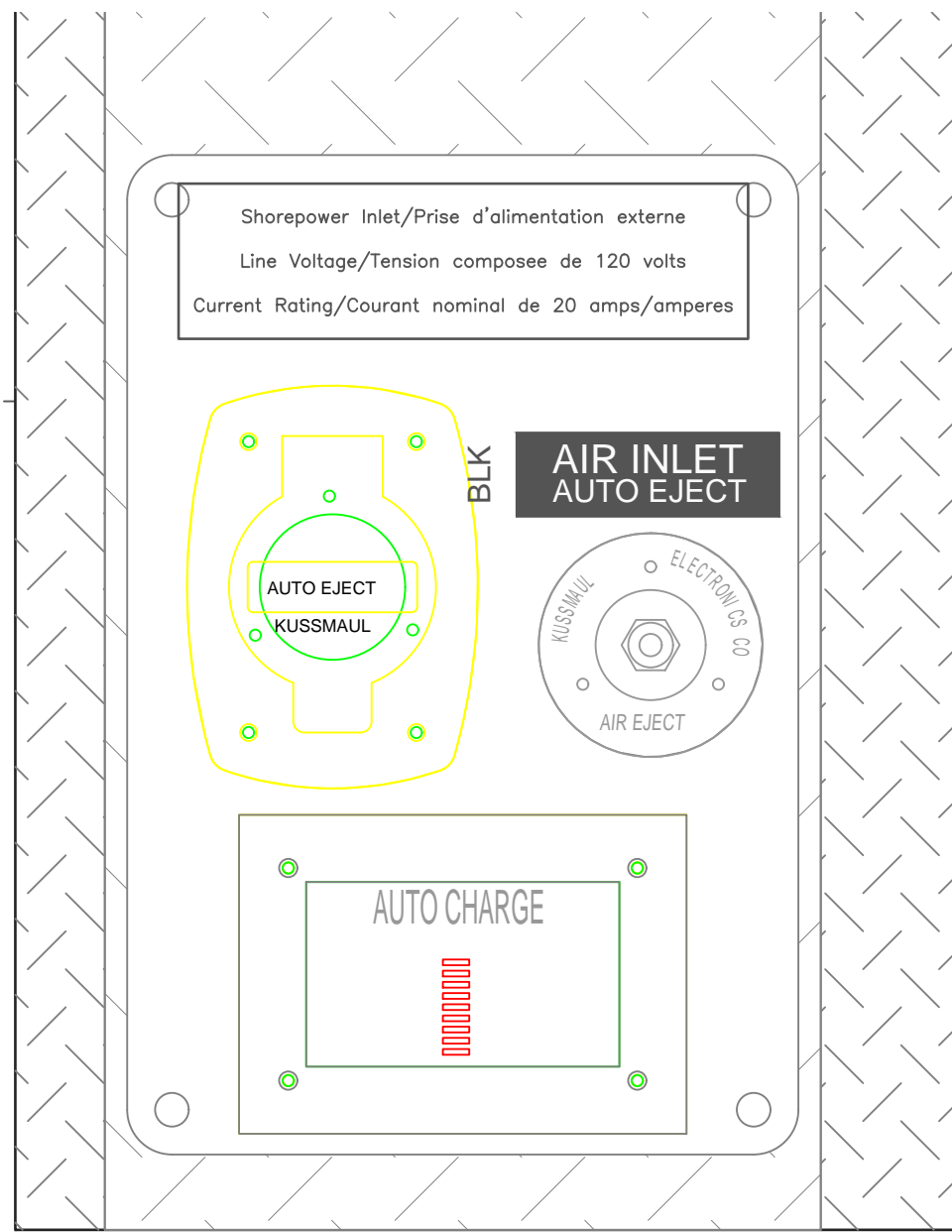
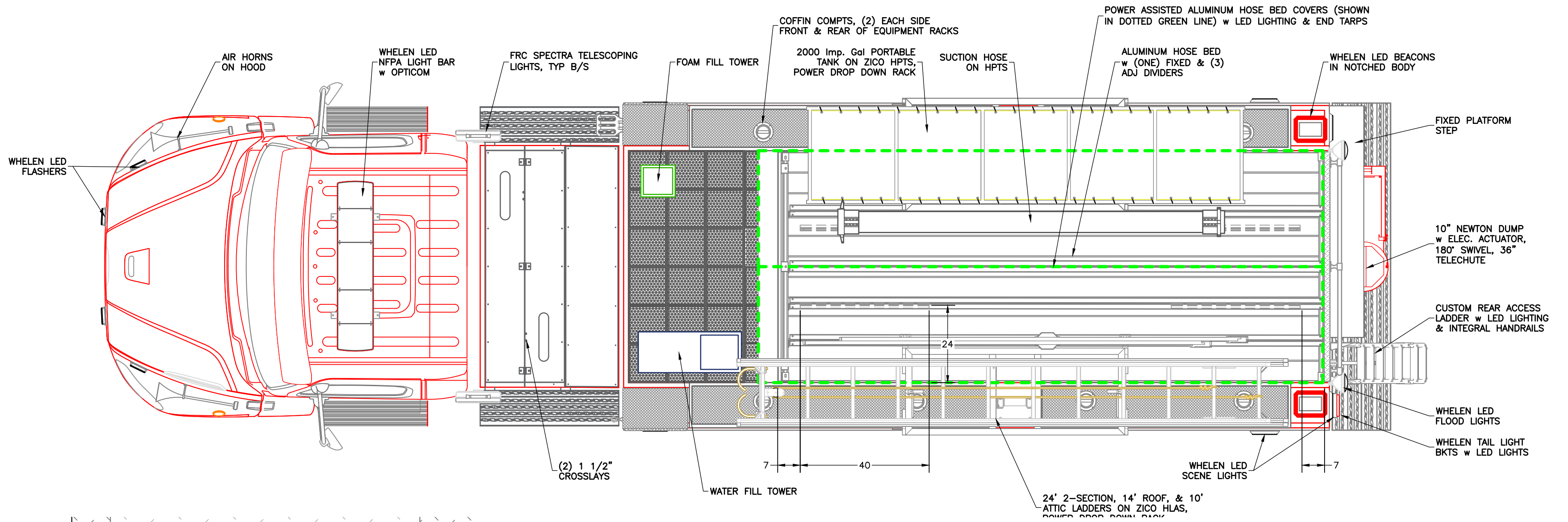

-ALL ALUMINUM CONSTRUCTION - ALL DIMENSIONS ARE IN INCHES

REV	DESCRIPTION	BY	DATE
2	UPDATED TO MATCH CHANGE ORDER B	HDS	OCT 3, 2025
1	ADJUSTED PUMPHOUSE STAINLESS AND PLUMBING LAYOUT	JOL	2025-08-12
0	FIRST ISSUE		

BROOKFIELD
FIRE DEPARTMENT

JOB No. 23142

DRAWN BY HDS

DATE JUNE 16, 2025

METALFAB LTD.
847 CENTRAL ST. CENTREVILLE
NB. CANADA E7K 2E8

TITLE GENERAL ARRANGEMENT

DRAWING NO. 23142-19 PG 2 OF 3

REV 2

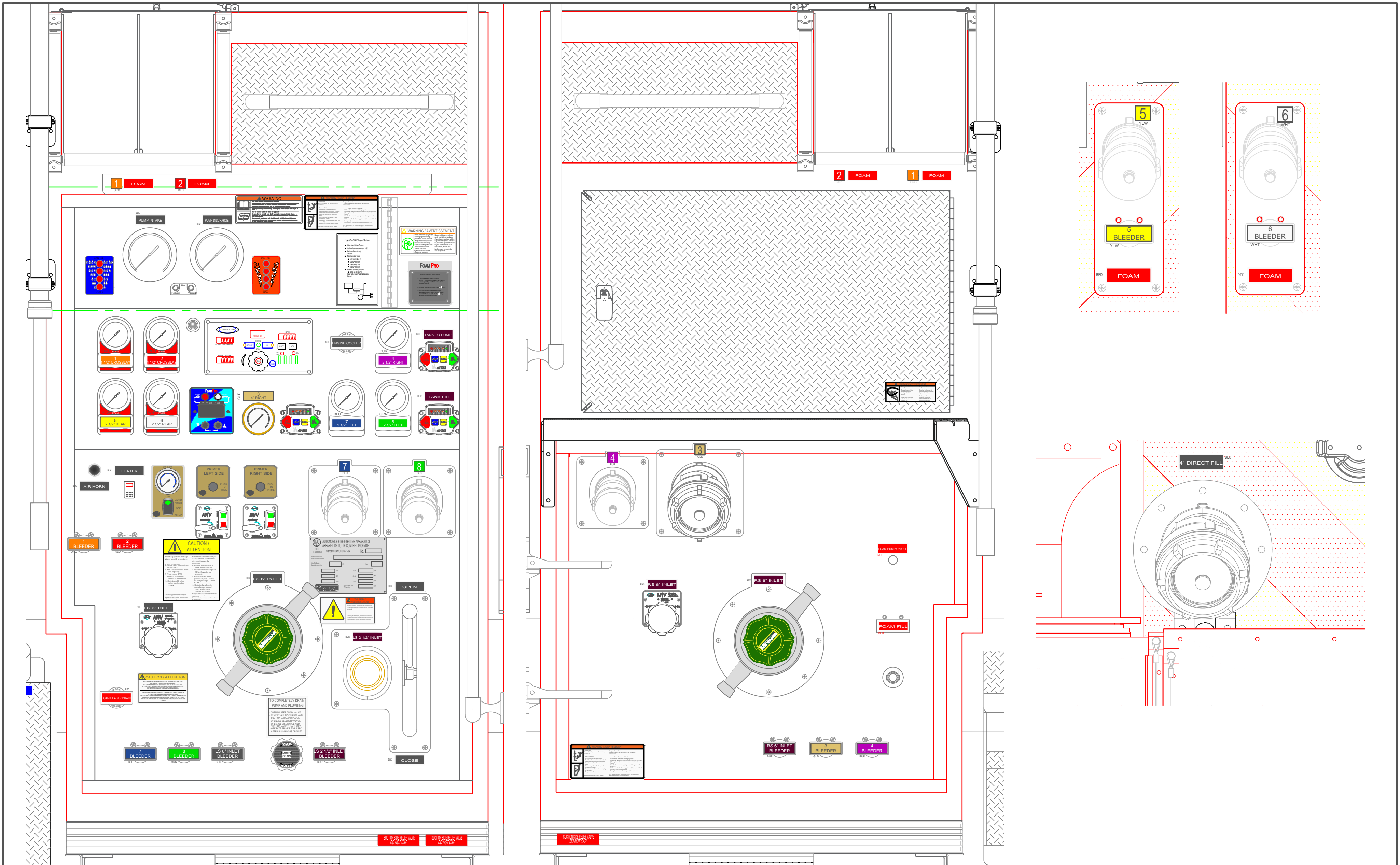

-ALL ALUMINUM CONSTRUCTION - ALL DIMENSIONS ARE IN INCHES

REV	DESCRIPTION	BY	DATE
2	UPDATED TO MATCH CHANGE ORDER B	HDS	OCT 3, 2025
1	ADJUSTED PUMPHOUSE STAINLESS AND PLUMBING LAYOUT	JOL	2025-08-12
0	FIRST ISSUE		
	REVISIONS		

BROOKFIELD FIRE DEPARTMENT		TITLE OPERATOR'S PANELS	
JOB No.	23142		
DRAWN BY	HDS		
DATE	JUNE 16, 2025		
METALFAB LTD. 847 CENTRAL ST. CENTREVILLE NB. CANADA E7K 2E8		DRAWING NO.	23142-19 PG 3 OF 3
		REV	2

